



Capacity5-.200.tons.....
 Stroke44-.62.in.....
 Maximum Pressure10,000.psi.....

- Plated piston to resist scoring & corrosion.
- Low profile, high tonnage design.
- Rod wiper protects inner cylinder from dirt.

RFS20 Shown



HAND PUMPS - pages 31 - 41
 Simplex carries the widest variety of Hand Pumps for specific applications.

| Model | Base Mounting Hole Dimensions (in) |
|-------|--------------------------------------|
| R50 | .22 through x .36 C' Bore (.25 Deep) |
| RFS10 | .28 through x .42 C' Bore (.31 Deep) |
| RFS20 | .39 through x .62 C' Bore (.39 Deep) |

Simplex RFS Series cylinders provide the ideal fit and force required for most bridge lifting and pier cap maintenance jobs.

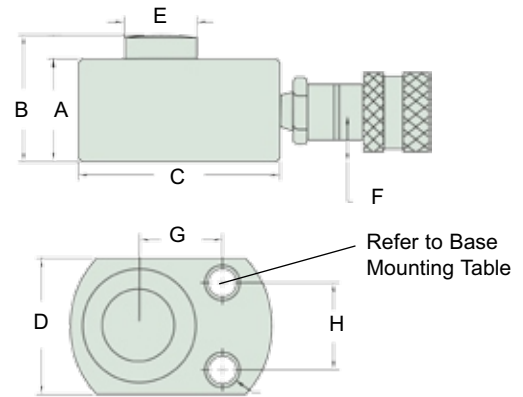

| Model | Cap. (tons) | Stroke (in) | Oil Cap. Req'd (cu.in.) | Ram Bore Dia. (in) | Effective Area (sq.in.) | Pressure @ Cap. (psi) | A | B | C | D | E | F | G | H | Wgt. (lbs) |
|--------|-------------|-------------|-------------------------|--------------------|-------------------------|-----------------------|---------------------|----------------------|------------------|-----------------|------------------|-----------------------|------------|------------|------------|
| | | | | | | | Minimum Height (in) | Extended Height (in) | Body Length (in) | Body Width (in) | Piston O.D. (in) | Base to Port C/L (in) | Width (in) | Width (in) | |
| R50 | 5 | .62 | .6 | 1.13 | .99 | 10,000 | 1.62 | 2.25 | 2.56 | 1.62 | 1 | .75 | 1 | 1.13 | 2.5 |
| RFS10 | 10 | .44 | 1 | 1.68 | 2.24 | 8,940 | 1.68 | 2.13 | 3.25 | 2.19 | .75 | .75 | 1.34 | 1.41 | 3.3 |
| RFS20 | 20 | .44 | 1.9 | 2.38 | 4.43 | 9,030 | 2.03 | 2.47 | 4 | 3 | 1.13 | .75 | 1.56 | 1.93 | 6 |
| RFS30 | 30 | .5 | 3.2 | 2.87 | 6.49 | 9,250 | 2.31 | 2.81 | 4.5 | 3.75 | 1.38 | .75 | --- | --- | 8.5 |
| RFS50 | 50 | .62 | 6 | 3.5 | 9.62 | 10,400 | 2.62 | 3.25 | 5.5 | 4.5 | 1.75 | .75 | --- | --- | 14.3 |
| RFS75 | 75 | .62 | 10 | 4.5 | 15.90 | 9,440 | 3.13 | 3.75 | 6.5 | 5.5 | 2.13 | .75 | --- | --- | 24.5 |
| RFS100 | 100 | .62 | 12.3 | 5 | 19.63 | 10,200 | 3.38 | 4 | 7 | 6 | 2.5 | .75 | --- | --- | 31 |
| RFS150 | 150 | .56 | 17.2 | 6.25 | 30.66 | 9,785 | 3.93 | 4.5 | 8.5 | 7.5 | 3 | .93 | --- | --- | 50.5 |
| RFS200 | 200 | .58 | 17.3 | 6.25 | 30.66 | 9,785 | 3.93 | 4.5 | 8.5 | 7.5 | 3 | .93 | --- | --- | 50.5 |